

Setting Up VeriCite Plagiarism Tool in Canvas

You will find VeriCite tool within the Assignment tool.

Go to Canvas and in the course you want to add the VeriCite.

Click on  or if you are in the **Module** screen, click 

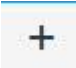
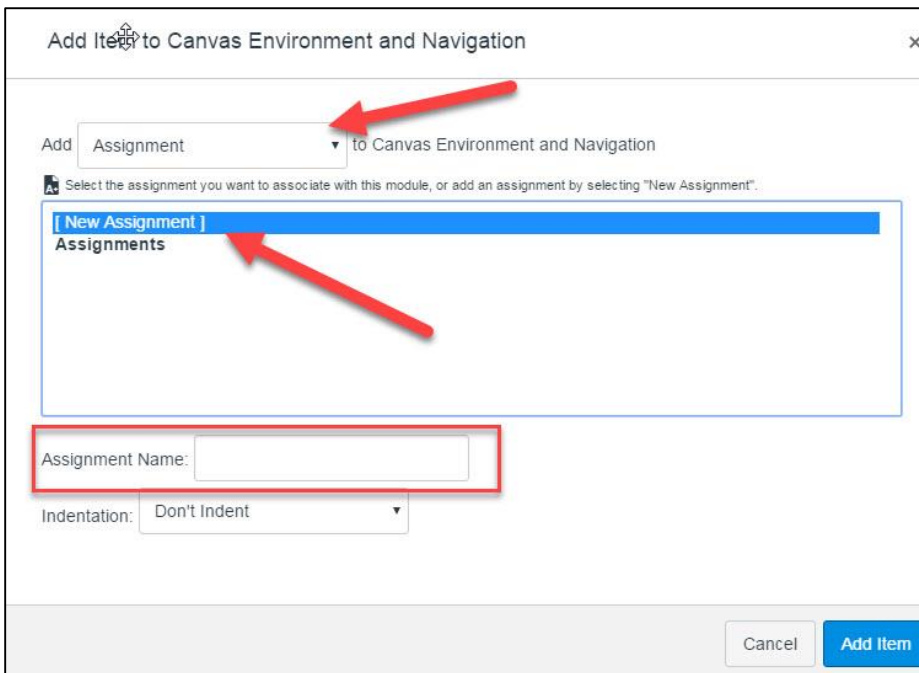

Add Item to Canvas Environment and Navigation

Add to Canvas Environment and Navigation

Select the assignment you want to associate with this module, or add an assignment by selecting "New Assignment".

[New Assignment]
Assignments

Assignment Name:

Indentation:

Cancel Add Item

Make sure to click *New Assignment* so the **Assignment Name** appears.

Enter a name for the Assignment (you can change it later)

Click .

Click the newly created Assignment.

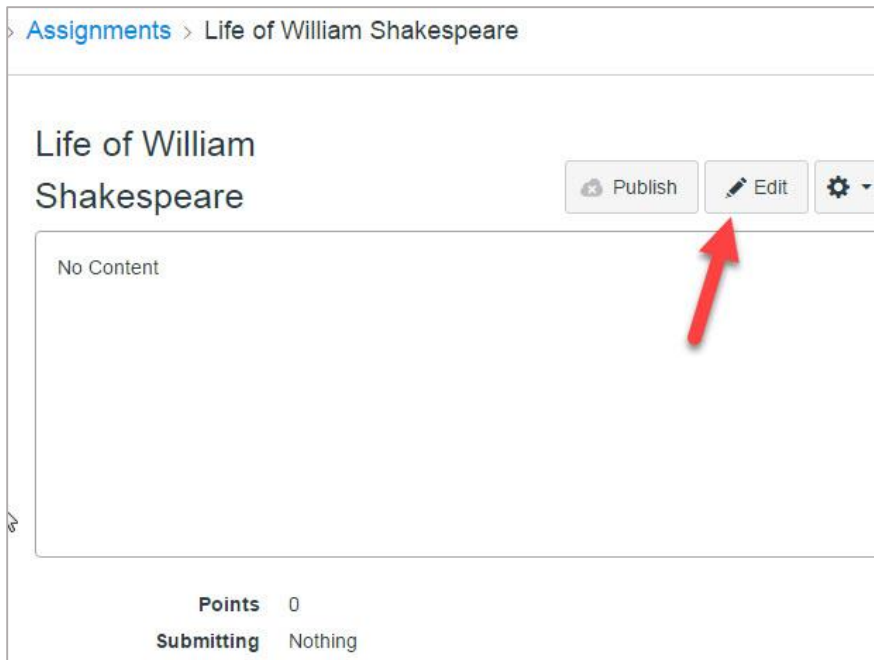

Click the **Edit** button.

Using the scroll on the right, slide down to **Submission**.

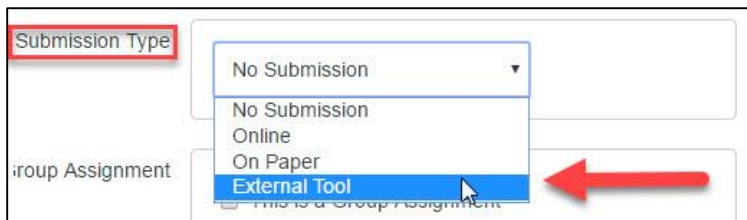

Click the drop-down menu and choose **External Tool**.

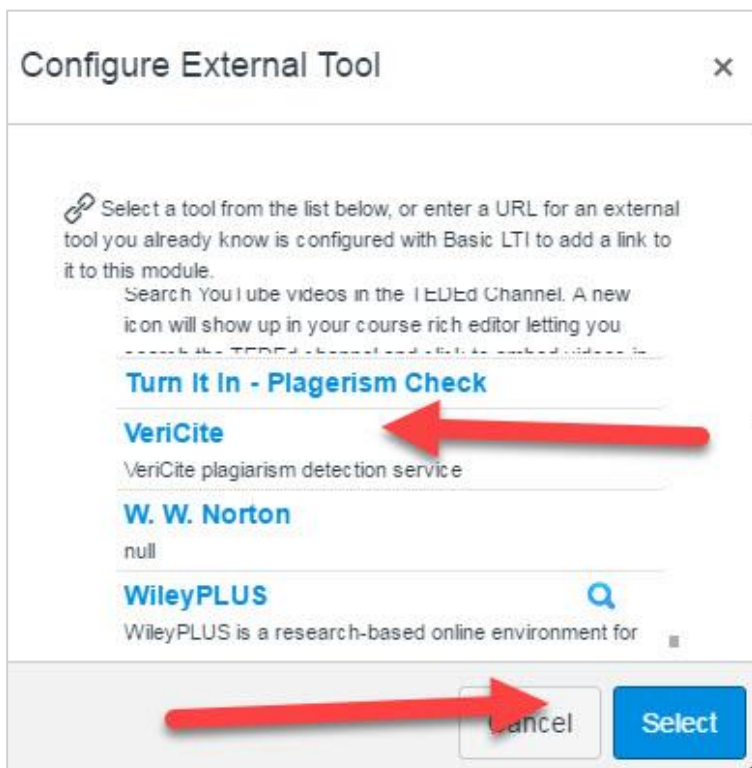

Double click the **Select** button and scroll down the list.

Locate **VeriCite**

Click the **Select** button

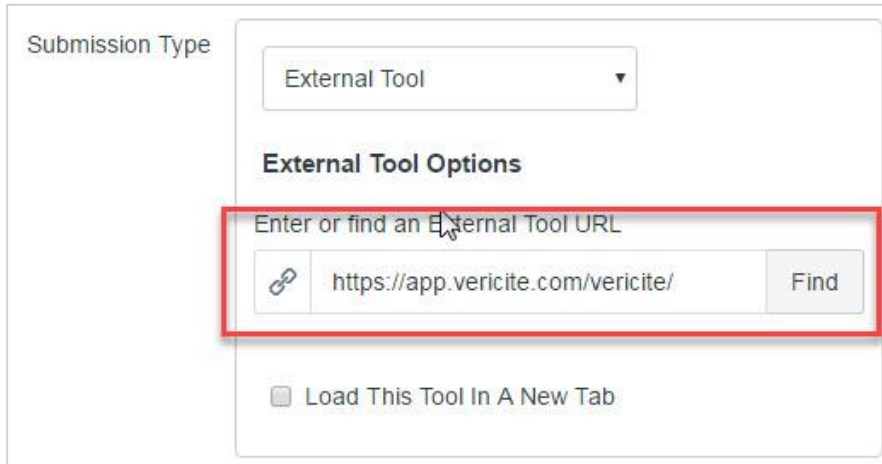

The screenshot shows a form titled "External Tool Options". At the top, there is a dropdown menu for "Submission Type" with "External Tool" selected. Below this is a section for "External Tool Options" which contains a text input field labeled "Enter or find an External Tool URL". The URL "https://app.vericite.com/vericite/" is entered in the field, and a "Find" button is to its right. A red box highlights the URL input field and the "Find" button. Below the URL field is a checkbox labeled "Load This Tool In A New Tab" which is currently unchecked.

NOTE: DO not make any changes in the link box.

If you want VeriCite to open in a new tab of the browser, be sure to click **Load This Tool in a New Tab**

Complete the rest of the Assignment settings as needed.

When done, click the **Save** or **Save & Publish** at the bottom.

NOTE: This is not available to your students unless your class and module and course is open.

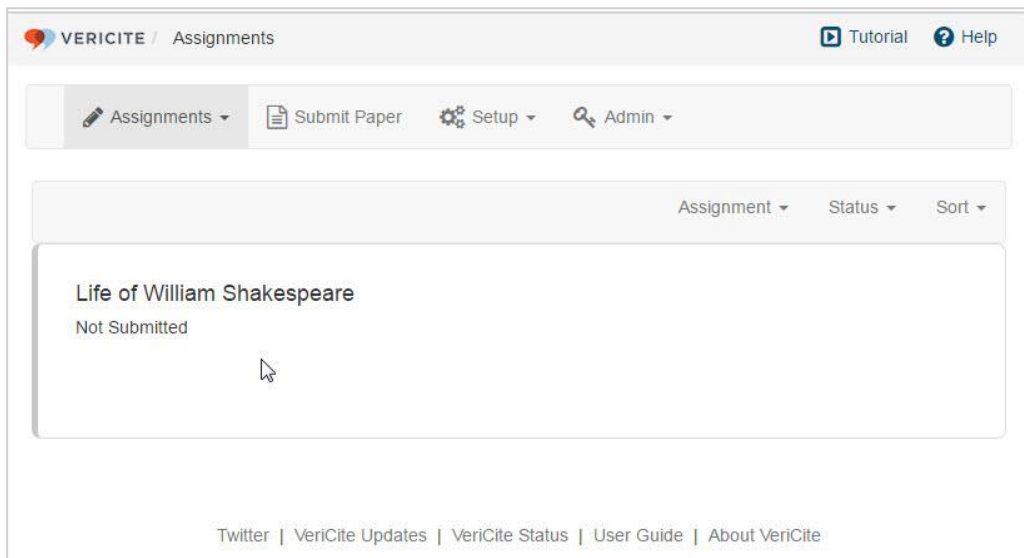

The screenshot shows the VeriCite Assignments page. The header includes the VeriCite logo, the text "VERICITE / Assignments", and links for "Tutorial" and "Help". Below the header is a navigation bar with "Assignments", "Submit Paper", "Setup", and "Admin" options. The main content area shows a list of assignments with columns for "Assignment", "Status", and "Sort". One assignment is visible: "Life of William Shakespeare" with a status of "Not Submitted". A mouse cursor is hovering over the assignment card. At the bottom of the page, there are links for "Twitter", "VeriCite Updates", "VeriCite Status", "User Guide", and "About VeriCite".

Note: This full process needs to be done for each additional paper to connect properly to the gradebook.